

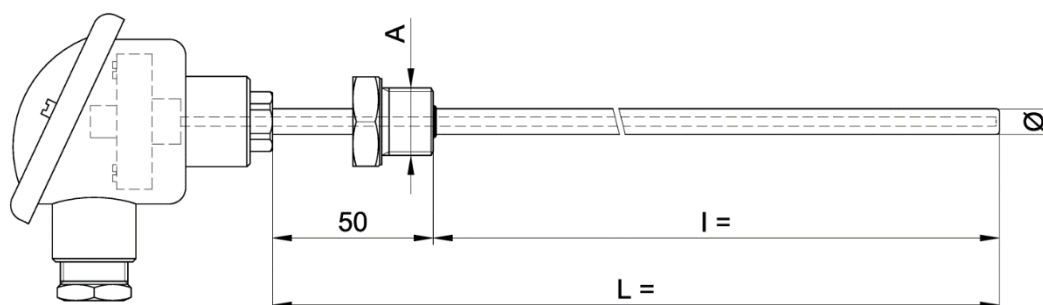

RTD probe with connection head suitable for temperature up to 500°C

- Extractable measuring insert - single or dual RTD, adjustable of the cable gland - optional transmitter



CONTROL PROCESS srl Sede Operativa Via Anzalone 22 95024 Acireale Catania (IT)

Tel + 39 095 721 38 41 mail info@controlprocess.it



Series TE-PT100 – TE-PT100 Technical features

Product type	probe
Type of sensor	thermoresistance
Sensor construction type	with mineral compact insulation (M.I.C.)
Sensor protection	Metal sheath
Removable insert	yes
Number of elements	single 4-wire double 6-wire double 8-wire
Output signal type	thermoresistance 4 ... 20 mA
Insulation resistance	100 M Ω @ 100 Vcc.
Sheath diameter (d)	diameter 6 – 8 mm
Realizable sheath lengths (L) = Subject to feasibility check	100 mm, 150 mm, 200 mm, 250 mm, 300 mm, 350 mm 400 mm, 800 mm
Dimensional notes	Length other than those listed can be produced for minimum quantities to be agreed (after our feasibility study)
Fixing system	threaded connection
Process connection Cyl. GAS in accordance UNI-ISO 228 Con. Gas in accordance UNI-ISO 7-1 NPT accordance ANSI/ASME B 1.20.1 Metriche secondo UNI-ISO 4335-64	¼" – 3/8" ½" – ¾" gas UNI-ISO 228 ¼" – 3/8" ½" – ¾" NPT No threaded connection
Immersion (l) =	100 mm, 150 mm, 200 mm, 250 mm, 300 mm, 350 mm 400 mm, 800 mm
Connection head / junction	DIN B (PG16) head
Connection head	coated aluminium
Inside connection head	ceramic terminal block metal disc for transmitter 4 ... 20 mA transmitter standard 4 ... 20 mA transmitter Ex ia Nylon terminal block
International protection marking IEC 60529	IP 65/67

CONTROL PROCESS srl Sede Operativa Via Anzalone 22 95024 Acireale Catania (IT)

Tel + 39 095 721 38 41 mail info@controlprocess.it



Series TE-PT100 – TE-PT100 Technical features

Fixing system	threaded connection
Process connection Cyl. GAS in accordance UNI-ISO 228 Con. Gas in accordance UNI-ISO 7-1 NPT accordance ANSI/ASME B 1.20.1 Metriche secondo UNI-ISO 4335-64	1/4" – 3/8" 1/2" – 3/4" gas UNI-ISO 228 1/4" – 3/8" 1/2" – 3/4" NPT No threaded connection
Immersion (I) =	50 – 100 – 150 – 200 – 250 – 300 – 350 mm
Dimensional notes	Length other than those listed can be produced for minimum quantities to be agreed (after our feasibility study)
Sensing part connection	DIN B
Connection head / junction	DIN B (output PG16) head
Connection head / junction box material	coated aluminium
Inside connection head	ceramic terminal block metal disc for transmitter 4 ... 20 mA transmitter standard 4 ... 20 mA transmitter Ex ia Nylon terminal block
International protection marking IEC 60529	IP 65/67

CONTROL PROCESS srl Sede Operativa Via Anzalone 22 95024 Acireale Catania (IT)

Tel + 39 095 721 38 41 mail info@controlprocess.it